

STANLEY®

90L GENERAL PURPOSE WHEELBARROW ASSEMBLY GUIDE

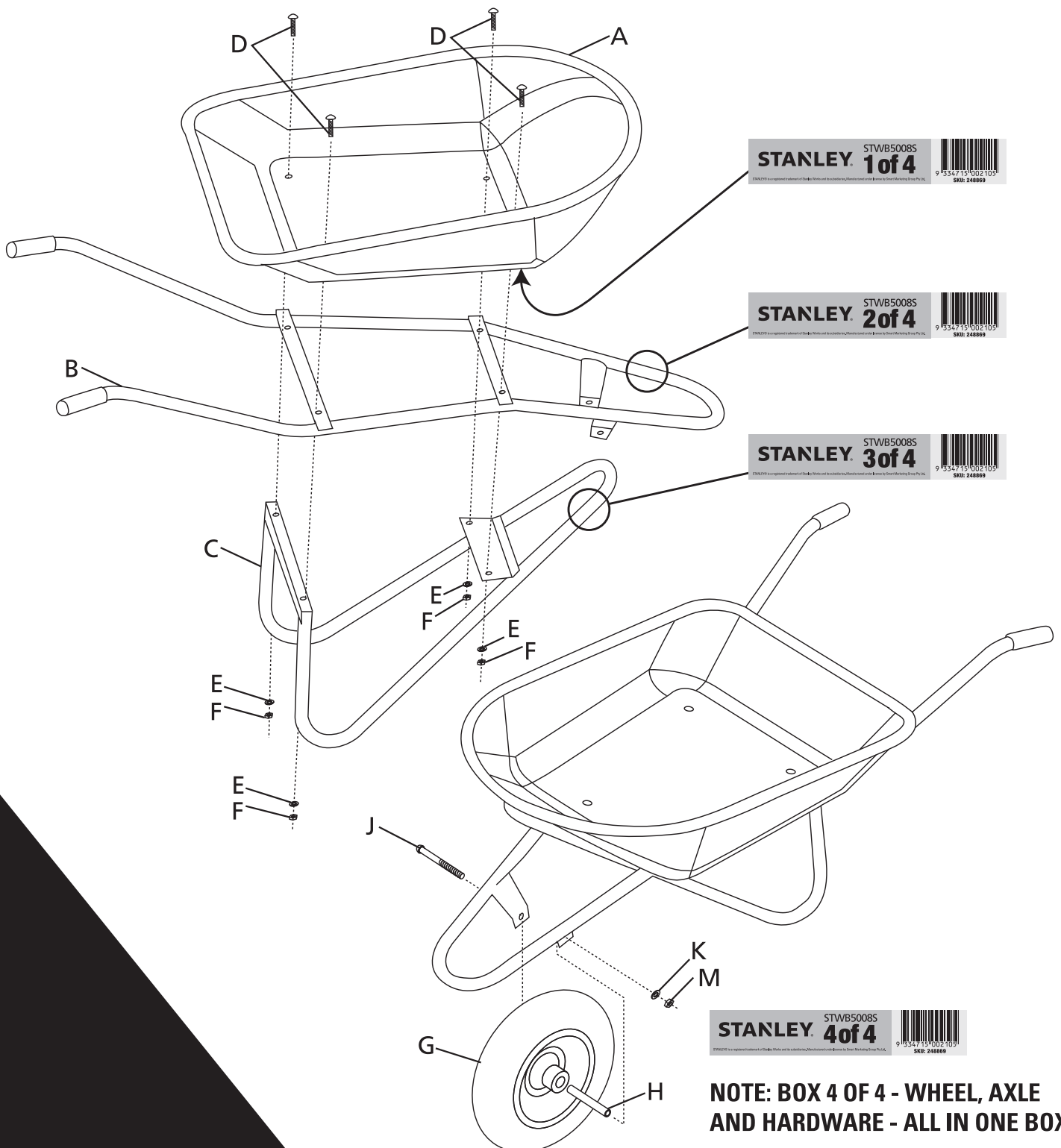

STWB5008S

STANLEY® is a registered trademark of Stanley Works and its subsidiaries.
Manufactured under license by Smart Marketing Group Pty Ltd.

PARTS LIST

Part	Description	Qty	Part	Description	Qty
A	Steel Tub (labelled 1 of 4)	1	B	Handle Frame (labelled 2 of 4)	1
C	Leg Frame (labelled 3 of 4)	1			
The following are all in carton labelled 4 of 4					
D	8 x 25mm Bolts	4	E	8mm Flat washers	4
F	8mm Nylok nuts	4	G	Wheel (4.00 x 8)	1
H	10 x 140mm Axle	1	J	10 x 160mm Bolt	1
K	10mm Flat washer	1	M	1 x 10mm Nylok nut	1

ASSEMBLY GUIDE

1. Position the tub (A), handle frame (B) and the leg frame (C) in order.
 2. Position and push 1 bolt (D) through all items noted in step 1.
 3. Place a washer (E) and secure with a Nylok nut (F). Do up finger tight.
 4. Now position and push the other 3 bolts (D) through all items, then place a washer (E) and secure with a Nylok nut (F) on each bolt (A). Do up finger tight.
 5. Locate the axle (H) through the wheel (G).
 6. Push the wheel bolt (J) through the frame (B), axle (H) and secure with a washer (K) and secure with a Nylok nut (M).
 7. Using a screw driver and a spanner fully tighten all bolts and nuts.
 8. Check tyre pressure should be no more than 20PSI.
- Note: Periodically check all bolts and nuts for tightness, if required tighten. Periodically check the tyre pressure and if required pump up, never inflate above 20PSI.