

STANLEY®

72L GENERAL PURPOSE WHEELBARROW POLY POURER TUB ASSEMBLY GUIDE

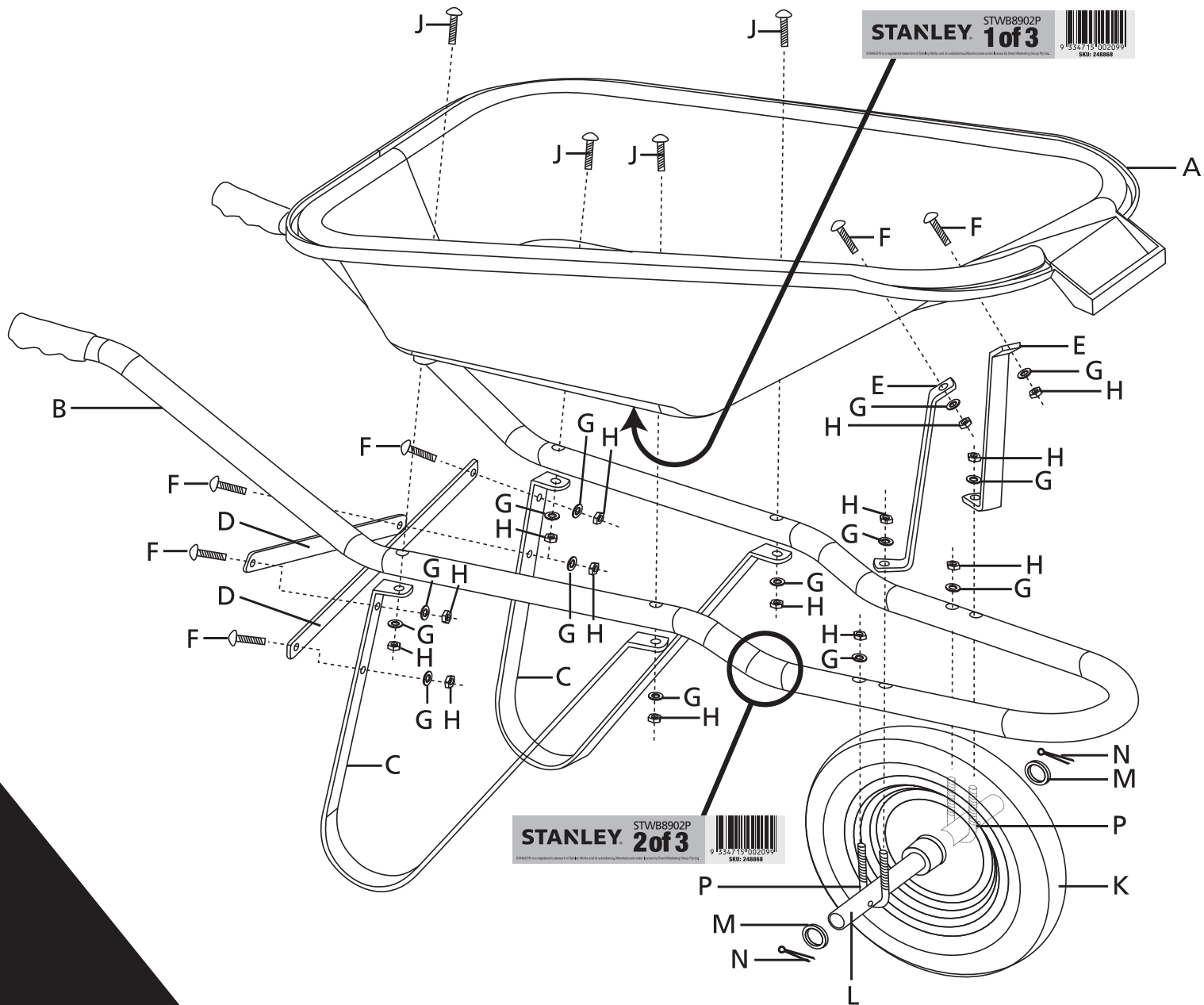

**NOTE: WHEEL, AXLE, LEGS AND
HARDWARE - ALL IN BOX 3 OF 3**

STWB8902P

STANLEY® is a registered trademark of Stanley Works and its subsidiaries.
Manufactured under license by Smart Marketing Group Pty Ltd.

PARTS LIST

Part	Description	Qty	Part	Description	Qty
A	Poly Tub (labelled 1 of 3)	1	B	Handle Frame (labelled 2 of 3)	1
The following are all in carton labelled 3 of 3					
C	Curved leg frame	2	D	Flat leg bar	2
E	Tub stays	2	F	8 x 28mm bolts	6
G	8mm Flat washers	14	H	8mm Nylok nuts	14
J	8 x 55mm Bolts	4	K	Wheel (4.00 x 8)	1
L	20mm Axle	1	M	20mm Washers	2
N	3 x 40mm Split pins	2	P	Axle 8 x 25 x 70mm "U" bolts	2

ASSEMBLY GUIDE

1. Position the 2 curved leg frames (C) and the 2 flat leg bars (D) and assemble using 4pcs bolt (F), washer (G) and Nylok nut (H). Do up finger tight.
2. Position the tub (A), handle frame (B) and the assembled leg frame in order.
3. Position and push 1 bolt (J) through all items.
4. Place a washer (F) and secure with a Nylok nut (G). Do up finger tight.
5. Now position and push the other 3 bolts (J) through all items, then place a washer (G) and secure with a Nylok nut (H) and each bolt (J). Do up finger tight.
6. Attached the 2 tub stays (E) to the poly tub (A) using bolts (J), washers (G) and Nylok nuts (H). Do up finger tight.
7. Position and secure the 2 axle "U" bolts (P), and secure using washers (G) and Nylok nuts (H). Do up finger tight. NOTE: Each tub stay in is positioned on the front leg of the "U" bolt (P) before securing with the washer (G) and Nylok nut (H). Do up finger tight.
8. Position the axle (L) through the "U" bolt (P), wheel (K) and "U" bolt (P).
9. At each end of the axle (L) place the washer (M) and secure with a split pin (N). Open and rotate the longer leg on the split pin (N) so that it is secure.
10. To finish you will need to tighten all bolts and nuts, using a screw driver and a spanner.
11. Check tyre pressure should be no more than 20PSI.

Note: Periodically check all bolts and nuts for tightness, if required tighten. Periodically check the tyre pressure and if required pump up, never inflate above 20PSI.