

# STANLEY®

## PETROL HEDGE TRIMMER 4 STROKE 26CC



**MODEL NO.  
SXP42604**

For service, spare parts or product information,  
please contact Smart Marketing Group Pty. Ltd.

**AUST. 1300 660 457    N.Z. 0800 474 876**

[www.stanleyproducts.com.au](http://www.stanleyproducts.com.au)

# CONTENTS

Section	Page
Contents	2
Suggested Applications	2
2 Years Warranty / Serial Number	2
Specifications	3
Introduction	4
Express Warranty Statement	4
Complete Warranty Statement	5
Important Safety Instructions	6 - 8

Section	Page
Description & Components	9
Unpacking	10
Preparation	10 – 13
Operation	13 - 17
Maintenance	18 – 21
Trouble Shooting	22
Service Log	23
Contact Information	24

## SUGGESTED APPLICATIONS

These are some suggested articles which could be used by this Hedge Trimmer:

- Hedges
- Classic Garden design
- Trees

## 2 YEARS WARRANTY

**2 YEARS WARRANTY**

### PLEASE CONTACT CUSTOMER SERVICE

SMART MARKETING GROUP PTY. LTD.

Australia: 1300 660 457

New Zealand: 0800 474 876

Operating times: Monday – Friday

8.00am - 5.00pm Australian Eastern Standard Time (AEST)

Please take note of serial number and write here for ease of reference:

Serial Number: \_\_\_\_\_

Date of Purchase: \_\_\_\_\_

Place of Purchase: \_\_\_\_\_

Receipt Number: \_\_\_\_\_

# STANLEY®

## OWNER'S OPERATING MANUAL PETROL HEDGE TRIMMER 4 STROKE 26CC MODEL NO. SXPG42604

### SPECIFICATIONS

Engine type.....	4-stroke, air cooled
Engine displacement.....	26cc
Engine max. speed.....	11000min <sup>-1</sup>
Fuel tank capacity.....	280ml
Fuel type .....	91 Unleaded petrol
Engine lubricant oil type .....	4 Stroke oil SAE 30, SAE 10W-30 or SAE 10W-40
Starting system.....	Recoil starter
Spark plug type.....	TORCH CMR5H or NGK CMR5H
Cutting length.....	480mm
Blade length.....	550mm
Blade speed .....	2000/min
Blade tooth space.....	35mm
Max. cutting diameter .....	28mm

### THANK YOU FOR BUYING A STANLEY 4 STROKE PETROL HEDGE TRIMMER

Your new petrol Hedge Trimmer has been engineered and manufactured to STANLEY's high standard of dependability, ease of operation and operator safety. Properly cared for, it will give you years of rugged, trouble free performance. If you use your petrol Hedge Trimmer properly and only for what it is intended, you will enjoy years of safe, reliable service.



**CAUTION: Carefully read through this entire owner's manual, paying close attention to the general safety rules and rules for safe operation, before using.**

**KEEP THIS MANUAL FOR FUTURE REFERENCE**

# INTRODUCTION

Dear Customer,

Thank you for purchasing this Hedge Trimmer which has passed through our extensive quality assurance processes. Every care has been taken to ensure that it reaches you in perfect condition. However, in the unlikely event that you should experience a problem, or if you require any assistance please do not hesitate to contact us.



**If you have a problem, call customer service (phone number to the right), do not return this Hedge Trimmer to the place of purchase.**

## CUSTOMER SERVICE

**Australia: 1300 660 457**

**New Zealand: 0800 474 876**

**Operating times: Monday – Friday**

**8.00am - 5.00pm**

Australian Eastern Standard Time (AEST)

## EXPRESS WARRANTY STATEMENT - HEDGE TRIMMER

You are not required to do anything to register your Hedge Trimmer purchase. Please attach the purchase receipt to this manual and ensure both are kept safe. We hope you enjoy your new Hedge Trimmer, and if you have any problems call customer service on the above phone numbers. Do not return to place of purchase.

Smart Marketing Group Pty Ltd (SMG) warrants that this Hedge Trimmer will be free from manufacturing faults or defects for 2 years from the date of purchase, providing original purchase receipt is kept and shown when needed and is subject to the terms and conditions below.

If a warranty fault appears within the warranty period, SMG reserves the right to replace or repair the product. In the event that SMG chooses to replace the product, this original warranty will expire at the original date. If the product includes various accessories or components, only the defective accessory or component will be replaced or repaired.

SMG reserves the right to replace defective parts of the product with parts and components of similar quality, grade and composition where an identical part or component is not available.

Products presented for repair may be replaced by refurbished products of the same type rather than being repaired. Refurbished parts may be used to repair the products.

### What is covered.

- Manufacturing fault or defect.

### How to claim under this warranty.

- Call customer service, phone number at the top.
- Ensure you have the following: Original purchase receipt, Model of Hedge Trimmer, Serial number of Hedge Trimmer.
- Discuss the issue.
- Customer service will advise which authorised service agent to take the Hedge Trimmer to provided the issue is a warranty one.

- Take Hedge Trimmer to authorised service agent for repair.

### What is not covered.

- Commercial use of Hedge Trimmer.
- Use of Hedge Trimmer in a commercial premises.
- Damage or deterioration due to transport.
- Damage caused by negligence, misuse or abuse.
- Any corrosion or rusting.
- Damage caused by incorrect set up and start up.
- Replacement parts due to general wear and tear.
- Hedge Trimmer with serial number defacement, modification or removal.
- Hedge Trimmer which have been serviced by other than an authorised SMG service agent.
- Hedge Trimmer with no original purchase receipt.
- Hedge Trimmer which have been on sold, not original purchaser.
- Damage due non-servicing of Hedge Trimmer as is required by this manual.
- Blockages / damage caused by dust, dirt, spiders webs or insects.
- Damage caused by the incorrect fitting of accessories.
- Damage caused by overloading, overworking the Hedge Trimmer.
- Damage to attached equipment or third party accessories.
- Damage caused by attached equipment or third party accessories.

# COMPLETE WARRANTY STATEMENT - HEDGE TRIMMER

As soon as you have purchased the Hedge Trimmer, we recommend that you check to make sure it is intact and that you read the operating instructions carefully before using it. The purchase receipt for this product is to be retained and must be presented if making a claim under the terms of the Smart Marketing Group (SMG) warranty. Bank account statements are not acceptable for proof of purchase.

This warranty does not cover Hedge Trimmer intended for hire or use in commercial applications or in commercial premises. The warranty will under no circumstances extend to reimbursement or payment of damages, whether direct, indirect or consequential. The warranty is void if there is evidence the Hedge Trimmer has been modified or tampered with in any way or used with unauthorised accessories without our consent.

SMG declines any responsibility or liability whatsoever arising from misuse or abuse, negligent handling of the Hedge Trimmer or if the product has not been installed or failure to comply with the relevant safety, operating, setting and maintenance instructions (see further in this manual).

The warranty does not extend to installation or disconnection costs.

Any item sent freight forward/collect for repair will be refused. Warranty repairs are free of charge, provided the appliance is delivered to our service department or authorised service agent. The Hedge Trimmer will need to be returned, adequately protected in a box. SMG will not be responsible for any in-transit loss or damage. Assistance under the warranty will only be made available if the request is made to our customer service team on the contact numbers listed below and proof of purchase is provided.

This is a repair only warranty you will need to take the Hedge Trimmer to the authorised service agent after contacting our customer service centre.

If the product includes various accessories or components, only the defective accessory or component will be replaced or repaired.

SMG reserves the right to replace defective parts of the product with parts and components of similar quality, grade and composition where an identical part or component is not available.

Products presented for repair may be replaced by refurbished products of the same type rather than being repaired. Refurbished parts may be used to repair the products.

Damage caused by third party accessories is not covered under this warranty.

Damage caused to attached equipment or third party accessories will not be covered under this warranty.

Rust and corrosion are not covered under this warranty.

If a warranty fault is found the freight cost will be credited to the owner. If no fault is found the product will be returned and any

costs associated with the service will be charged to the owner.

Blockages caused by spider webs, insects, dirt, accumulated dust or incorrect fuel are not covered by warranty. SMG reserves the right to replace or repair the appliance within the warranty period. Parts found to be defective due to a manufacturing default will be replaced free of charge.

In the event of SMG choosing to replace the appliance, the warranty will expire at the original date of purchase. If no warranty fault is found the owner will be advised and the product will be returned and any costs associated with the service will be charged to the owner.

Our goods come with guarantees that cannot be excluded under the Australian Consumer Law. You are entitled to a replacement or refund for a major failure and for compensation for any other reasonably foreseeable loss or damage. You are also entitled to have the goods repaired or replaced if the goods fail to be of acceptable quality and the failure does not amount to a major failure. The benefits of this warranty are in addition to any rights and remedies imposed by Australian State and Federal legislation that cannot be excluded.

In New Zealand, this SMG warranty is in addition to the conditions and guarantees which are mandatory as implied by the New Zealand Consumer Guarantee Act 1993. For service, spare parts or product information please contact customer service:

Australia: 1300 660 457

New Zealand: 0800 474 876

# IMPORTANT SAFETY INSTRUCTIONS

The purpose of safety rules is to attract your attention to possible dangers. The safety symbols and the explanations with them, require your careful attention and understanding. The safety warnings do not by themselves eliminate any danger. The instruction or warnings they give are not substitutes for proper accident prevention measures.



## SAFETY ALERT SYMBOL

Indicates danger, caution or warning. May be used in conjunction with other symbols or pictures.

Failure to obey a safety warning can result in serious injury to yourself or to others. Always follow the safety precautions to reduce the risk of fire, electric shock and personal injury.

Do not attempt to operate this tool until you have read thoroughly and completely understood the safety rules, etc. contained in this manual. Failure to comply can result in accidents involving fire, electric shock or serious personal injury. Save this Owner's Operating Manual and review it frequently for continual safe operation and for instructing others who may use this tool.

## INTENDED USE

This petrol hedge trimmer is designated with an engine displacement of 26 cc. The product is intended for trimming hedges, bushes and shrubs. Observe the technical data for the maximum cutting capacity. Do not cut branches exceeding the stated maximum capacity. This product is intended for private use only, not for any commercial applications. It may not be used for any purposes other than those described.



## WARNING

To reduce the risk of injury, the user must read and understand the operator's manual.



## WARNING

Do not attempt to operate this Trimmer until you have read thoroughly and understood completely all instructions, safety rules etc contained in this manual. Failure to comply may result in accidents involving fire, electric shock or serious personal injury. Save operator's manual and review frequently for continuing safe operation and instructing others who may use this tool.

## SPECIFIC SAFETY INSTRUCTIONS

Read the instructions with due care. Familiarise yourself with the settings and proper operation of the machine. Like all power equipment, this unit must be handled carefully.

## DO NOT EXPOSE YOURSELF OR OTHERS TO DANGER.

Follow these safety rules. Do not permit others to use this unit unless they are thoroughly responsible and have read and understood the Hedge Trimmer manual and are trained in its operation.

Always wear safety goggles for eye protection. Dress properly. Do not wear loose clothing or jewellery that could become caught in moving parts of the unit. Safe, sturdy, nonskid footwear should always be worn. Long hair should be tied back. It is recommended that legs and feet should be covered to protect from flying debris during operation.

Inspect the entire unit for loose parts (nuts, bolts, screws, etc.) and any damage before start and operation. Repair or replace as necessary before using the machine.

DO NOT USE any attachment with this power head other than the ones recommended by our manufacturer's replacement. Serious injury to the operator or bystanders could result as well as damage to the machine.

Keep the handles free from oil and fuel.

Do not operate the unit in insufficient lighting conditions.

Do not operate the unit when you are tired, when your concentration is impaired and/or under the influence of drugs, medication or alcohol.

Always use proper handles when trimming.

Do not smoke while filling tank.

Do not fill fuel in an enclosed room or near open flames. Ensure adequate ventilation.

Always store fuel in a properly marked container that is approved by local codes and ordinances for such usage.

Never remove the fuel tank cap while the engine is running.

# IMPORTANT SAFETY INSTRUCTIONS

Never start or run the product inside a closed room or building. Fumes from the exhaust contain dangerous carbon monoxide.

Never attempt to make engine adjustments while the unit is running. Always make engine adjustments with the unit resting on a flat, clear surface.

Do not use the unit if it is damaged or poorly adjusted. Never remove the unit's guard. Serious injury to the operator or bystanders could result as well as damage to the machine.

Keep children away. Onlookers should be kept at a safe distance from the work area, at least 15m (50ft) away.

Never leave the unit unattended while engine is running.

Do not use this unit for any job other than those for which it is intended as described in this manual.

Do not overreach. Keep proper footing and balance at all times.

Always use two hands to operate a hedge trimmer fitted with two handles.

Do not use this type of unit for sweeping away debris.

Follow instructions for assembling and operation.

Do not store the unit in a closed area where fuel vapours can reach an open flame from hot water heaters, furnaces, etc. Store in a locked, well ventilated area only.

Ensure safe and proper performance of your unit. Please only use original accessories. The use of any other accessories or attachments may cause a potential hazard or injury to the user, damage to the unit, and void this warranty.

If the unit will not be used for a long time, clean the unit completely, especially the fuel/oil tank, its surroundings, and the air cleaner.

When refuelling, be sure to stop the engine and confirm that it is cooled down. Never refuel when the engine is running or hot. When gasoline spills, be sure to wipe it up completely and dispose of those materials before starting the engine.

Stay clear of other workers or bystanders by at least 15 meters/50 feet.

Whenever approaching an operator of the unit, carefully call their attention and confirm that the operator stops the engine. Be careful not to startle or distract the operator which can cause an unsafe situation.

The engine should be turned off when the unit is moved between work areas.

Pay attention to loosening and overheating parts. If there is any abnormality of the unit, stop operation immediately and check the unit carefully. If necessary, have the unit serviced by customer support. Never continue to operate a unit which may be malfunctioning.

In start-up or during operation of the engine, never touch hot parts such as the muffler, the high voltage wire or the spark plug.

After the engine has stopped, the muffler is still hot. Never place the unit in any places where there are flammable materials (dry grass, etc.), combustible gasses or combustible liquids.

Pay special attention to operation in the rain or just after the rain as the ground may be slippery.

If you slip or fall to the ground, release the throttle lever immediately.

# IMPORTANT SAFETY INSTRUCTIONS

Be careful not to drop the unit or hit it against obstacles.

Before proceeding to adjust or repair the unit, be sure to stop the engine and detach the spark plug.

When the machine is placed in storage for a long time, drain fuel/oil from the fuel/oil tank and carburettor, clean the parts, move the machine to a safe place and confirm that the engine has cooled down.

Make periodic inspections to ensure safe and efficient operation. For a thorough inspection of your unit, contact customer support.

Keep the unit away from fire or sparks.

Keep your body warm, especially the head, neck, feet, ankles, hands and wrists.

Maintain good blood circulation by performing vigorous arm exercises during frequent work breaks and also by not smoking.

Limit the hours of operation.

If you experience discomfort, redness and swelling of the fingers followed by whitening and loss of feeling, consult your physician before further exposing yourself to cold and vibration.

Always wear ear protection. Loud noises for long periods can cause hearing loss, even permanent deafness.

Wear no-slip heavy duty work gloves to improve your grip on the handle. Gloves also reduce the transmission of machine vibration to your hands.

**WARNING:** The string head is still dangerous while the machine is coasting to a stop.

Do not lay the machine on the side; otherwise the fuel could spill out.

Fuel evaporation during refuelling and exhaust gases are harmful to the operator and people around the unit.

Ensure the fuel evaporation and exhaust gases will not drift to the face of operator and keep other people away from your working area.

Do not allow children or untrained individuals to use this unit.

## RESIDUAL RISKS

Even when the unit is used as prescribed it is not possible to eliminate all residual risk factors. The following hazards may arise in connection with the unit's construction and design:

1. Damage to lungs if an effective dust mask is not worn.
2. Damage to hearing if effective hearing protection is not worn.
3. Health defects resulting from vibration emission if the unit is being used over long periods of time or not adequately managed and properly maintained.

## WARNING

This unit produces an electromagnetic field during operation. This field may under some circumstances interfere with active or passive medical implants. To reduce the risk of serious or fatal injury, we recommend persons with medical implants to consult their physician and the medical implant manufacturer before operating this unit.



# DESCRIPTION

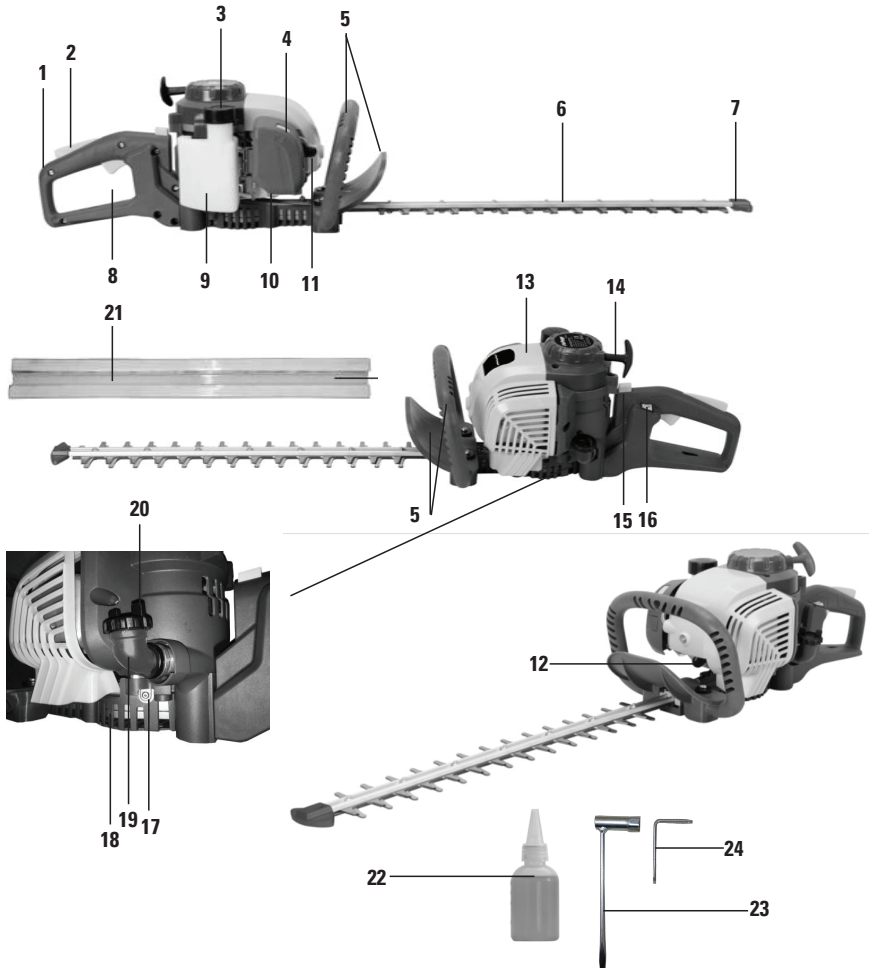

**For information regarding spare parts, please refer to contact details on the front of this manual**

- |   |                                    |                                   |
|---|------------------------------------|-----------------------------------|
| 1. Rear handle                            | 9. Fuel tank                       | 18. Gear box                      |
| 2. Throttle lockout                       | 10. Primer bulb                    | 19. Oil elbow                     |
| 3. Fuel tank cap                          | 11. Air filter cover               | 20. Oil cap                       |
| 4. Choke button                           | 12. Spark plug with cap            | 21. Blade cover                   |
| 5. Front handle/safety guard (integrated) | 13. Cylinder housing               |                                   |
| 6. Cutting blade                          | 14. Recoil Starter                 | <b>ACCESSORIES</b>                |
| 7. Tip protector                          | 15. Lock button for rotary handle  | 22. Oil bottle                    |
| 8. Throttle control                       | 16. ON/OFF switch                  | 23. Spanner for spark plug        |
|   | 17. lubrication nipple for gearbox | 24. Key for screws on the machine |

# UNPACKING

## CAUTION.

Unpack all parts and lay them on a flat, stable surface.

Remove all packing materials and shipping devices if applicable.

Make sure the delivery contents are complete and free of any damage. If you find that parts are missing or show damage do not use the product but contact call center.

Using an incomplete or damaged product represents a hazard to people and property.

Ensure that you have all the accessories and tools needed for assembly and operation. This also includes suitable personal protective equipment.

# PREPARATION

## USING THE RIGHT ENGINE OIL

 **CAUTION!** Lubricant has a major influence on engine performance and service life. The machine is equipped with a 4-stroke engine and must always been run using 4-stroke engine lubricant. Use high-quality oil. **DO NOT** fill the used oil. Failure to use clean oil of the correct type can cause premature engine wear and failure.

 **WARNING!** Do not change engine lubricant while it is hot. Accidental contact with hot engine lubricant could result in serious burns.

NOTE: This unit was shipped without oil in the crankcase. Oil must be added before starting the unit.

Attention: Must use API SF grade or the higher grade SAE 10W-30 lubricating oil (four stroke lubricating oil for the engine of car);

 **WARNING: OVERFILLING THE CRANKCASE MAY CAUSE SERIOUS PERSONAL INJURY.**

NOTE: Check the oil level before each use.

1. When the machine is filled with oil for the first time, you must use the oil bottle (22) with 60ml, then open the oil cap (20) and fill the oil into the oil tank of machine (see Fig. 1).
2. When the machine is used again after the first time, check the oil as always before use. Ensure the oil level is always close to the full position visually (see Fig. 2). Either Insufficient oil or overfilled oil both causes the malfunction of machine.

For best performance, engine lubricant should be changed entirely after every 25 hours of operation. Please pour out all the oil and refill the new lubricating oil instead.

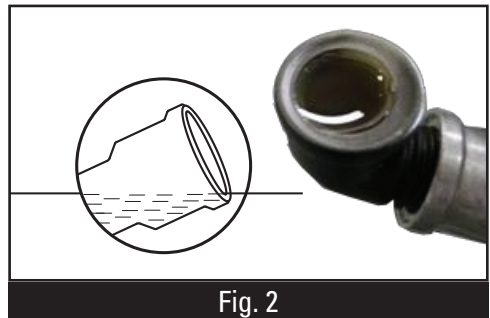

**NOTE: Never add oil to the fuel tank. This unit has 4 - stroke engine. DO NOT mix oil with petrol.**

# PREPARATION

## USING THE RIGHT PETROL

The use of old petrol is the most common cause of performance problems. Use only fresh, clean unleaded petrol.



**CAUTION!** Only use 91 RON Unleaded petrol

The lowest octane recommended is 91 RON Unleaded petrol. If you run the engine on a lower octane grade than 91 RON Unleaded fuel so-called knocking can occur. This gives rise to a high engine temperature, which can result in serious engine damage.

When working at continuous high revs a higher octane rating is recommended.

NOTE: Do not use E15 or E85 petrol (or petrol containing greater than 10% ethanol) in this product as it will damage the unit.

## PETROL SAFETY - TRANSPORT AND STORAGE

- Store and transport the machine and petrol so that there is no risk of any leakage or fumes coming into contact with sparks or naked flames, for example, from electrical machinery, electric motors, electrical relays/switches or boilers.
- When storing and transporting petrol always use approved containers intended for this purpose.
- When storing the machine for long periods the fuel tank must be emptied. Contact your local petrol station to find out where to dispose of excess petrol.
- Ensure the machine is cleaned and that a complete service is carried out before long-term storage.
- The transport guard must always be fitted to the cutting attachment when the machine is being transported or in storage.
- Secure the machine during transport.



**WARNING!** Petrol and petrol fumes are highly inflammable and can cause serious injury when inhaled or allowed to come in contact with the skin. For this reason observe caution when handling petrol and make sure there is adequate ventilation.



**WARNING!** Take care when handling petrol. Bear in mind the risk of fire, explosion and inhaling fumes.

## FUELLING



**WARNING!** Always shut off engine before fuelling. Never add petrol to a machine with a running or hot engine.

- Move at least 30 ft. from refueling site before starting engine.
- Do not smoke and stay away from open flames and sparks. Failure to safely handle petrol could result in serious personal injury.
- Never start the machine if you have spilt petrol on it. Wipe off the spillage and allow remaining petrol to evaporate.
- If the machine is leaking petrol. Check regularly for leaks from the fuel cap and fuel lines.
- Always use a fuel container with an anti-spill valve.  
  
Clean the area around the fuel cap. Contamination in the tank can cause operating problems.
- When refuelling, open the fuel cap slowly so that any excess pressure is released gently.
- Tighten the fuel cap carefully after refuelling.
- Always move the machine away from the refuelling area before starting. Bear in mind the risk of fire, explosion and inhaling fumes.

## FUELLING THE UNIT ACCORDING TO THE FOLLOWING PROCEDURE:

1. Position the unit with the petrol cap facing up.
2. Remove the petrol cap.
3. Place the petrol container spout into the fill hole on the petrol tank and fill the tank.

## NOTE: DO NOT OVERFILL THE TANK.

4. Wipe up any petrol that may have spilled.
5. Reinstall the petrol cap.
6. Move the unit at least 30 ft. (9.1 m) from the petrol container and the fuelling site before starting the engine.

# PREPARATION

## STARTING/STOPPING THE MACHINE

### CHECK BEFORE STARTING

- Inspect the working area. Remove any objects that could be thrown out.
- Check the cutting attachment. Remove the blade cover before use and never use blades that are dull, cracked or damaged.
- Check that the machine is in perfect working order. Check that all nuts and screws are tight.
- Make sure the gear housing is lubricated correctly. See instructions under the heading Gear housing.
- Check that the cutting attachment always stops when the engine is idling.
- Only use the machine for the purpose it was intended for.
- Make sure that the handle and safety features are in good working order. Never use a machine that lacks a part or has been modified outside its specifications.
- All covers must be correctly fitted and undamaged before you start the machine.
- Check oil levels (see Fig. 3)

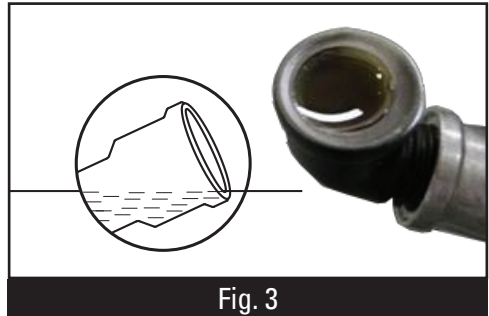

Fig. 3

## STARTING AND STOPPING



**WARNING!** The complete clutch cover and gear housing must be fitted before the machine is started, otherwise the clutch may come loose and cause personal injury.

Always move the machine about 3 metres from the refuelling position before starting. Place the machine on a firm surface. Remember that the blades may start to move when the engine is started. Make sure the blades cannot come into contact with any object. Make sure that no unauthorised persons are in the working area, otherwise there is a risk of serious personal injury. The safety distance is 15 metres.

# PREPARATION

## TO START A COLD ENGINE

Turn switch to "I" ON position.



Slowly press the primer bulb 5-10 times.  
NOTE: After the 7th press, fuel should be visible in the primer bulb. If it is not, continue to press the primer until you see fuel in the bulb.



Push the choke button in to set the choke to FULL CHOKE position. NOTE: Do not squeeze the throttle trigger because the choke will pop out automatically.



Pull the starter grip /cord until resistance is detected. Rapidly pull 3 to 5 times or until you hear engine turn over or begin to start. (see Fig. 4)



If engine does not start, release choke by squeezing throttle trigger and red choke button pops out.

Engine is now in the run position.

Rapidly pull starter grip/cord until engine starts. (see Fig. 4)

Allow the engine to run for 10 seconds, then squeeze throttle to provide fuel to engine and use for intended task.

Note: The choke button is only used when starting a cold engine. Never push the choke button in once the engine has been turned over or run. Otherwise the engine could be damaged or not run due to FULL CHOKE.

## STOPPING

The engine is switched off by moving the stop switch to the stop position. (see Fig. 5)

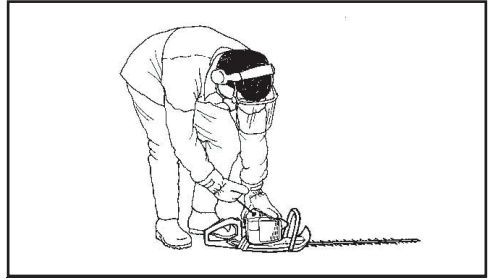

Fig. 4

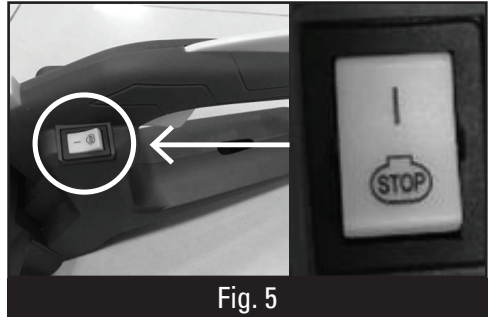

Fig. 5

# OPERATION

**WARNING!** The machine can cause serious personal injury. Read the safety instructions carefully. Learn how to use the machine.

**WARNING!** Do not touch the tool without first switching off the engine.

## SAFETY INSTRUCTIONS REGARDING THE SURROUNDINGS

- Never allow children to use the machine.
- Ensure that no-one comes closer than 15m while you are working.
- Never allow anyone else to use the machine without first ensuring that they have understood the contents of the operator's manual.
- Never work from a ladder, stool or any other raised position that is not fully secured. (see Fig. 6)
- Keep in mind that the operator is responsible for accidents or hazards occurring to other people or their property.

## SAFETY INSTRUCTIONS WHILE WORKING

- Always ensure you have a safe and stable working position.
- Always use both hands to hold the machine. Hold the machine in front of your body.
- Make sure that your hands and feet do not come near the cutting attachment when the engine is running. (see Fig. 7)

## REPAIR ANY DAMAGE.

- If anything jams in the blades while you are working, switch off the engine and wait until it has stopped completely before cleaning the blades. Disconnect the HT lead from the spark plug.

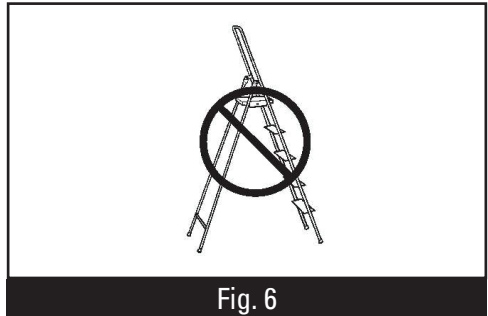

Fig. 6

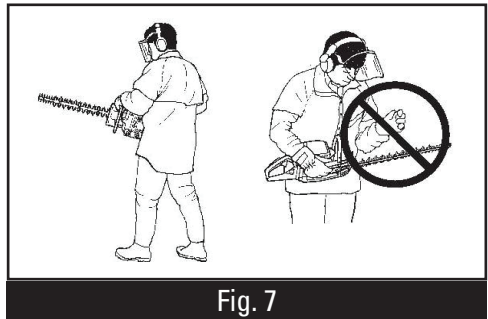

Fig. 7

# OPERATION

## TIPS FOR TRIMMING

- When the engine is switched off, keep your hands and feet away from the cutting attachment until it has stopped completely.
- Watch out for stumps of branches that can be thrown out during cutting.
- Do not cut too close to the ground. Stones and other objects can be thrown out.
- Check the working area for foreign objects such as electricity cables, insects and animals, etc, or other objects that could damage the cutting attachment, such as metal items.
- If any foreign object is hit or if vibrations occur stop the machine immediately. Disconnect the HT lead from the spark plug. Check that the machine is not damaged.

## SAFETY INSTRUCTIONS AFTER COMPLETING WORK

- The transport guard should always be fitted to the cutting attachment when the machine is not in use.
- Make sure the cutting attachment has stopped before cleaning, carrying out repairs or an inspection. Disconnect the HT lead from the spark plug.
- Always wear heavy-duty gloves when repairing the cutting attachment. This is extremely sharp and can easily cause cuts. (see Fig. 8)
- Store the machine out of reach of children.
- Use only original spare parts for repairs.

## BASIC WORKING TECHNIQUES

- Work with a swinging action from the bottom upwards when trimming sides.
- Adjust the throttle setting to suit the load.
- When trimming a hedge the engine should always face away from the hedge.
- Hold the machine as close to your body as possible to get the best balance.
- Make sure that the tip does not touch the ground.
- Do not rush the work, but work steadily until all the branches have been cut back cleanly.

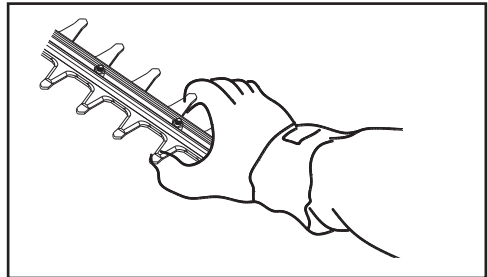

Fig. 8

## INSPECTION AND MAINTENANCE SCHEDULE

The maintenance interval is only a recommendation for machines in ordinary operating condition. If there are any abnormal signs from the machine, please do the proper inspection and maintenance immediately.

ITEM	HOURS OF OPERATION
Engine lubricant oil level	Every time before use
Loosened or lost screws	Every time before use
Damage of any part	Every time before use
Function of control elements	Every time before use
Fuel level	Every time before use
Leakage of oil or fuel	Every time before use
Engine oil replacement	Every 20 hours
Air filter cleaning	Every 20 hours but every 10 hours if work condition is dusty
Spark plug check	Every 20 hours

# OPERATION

## CUTTING

- Adjust the handle so that it fits the intended cut and start the product as described.
- Cut and remove branches exceeding the cutting capacity of this product using a proper pruner before operation.
- Move the cutting device lightly through the cutting surface in a sweeping motion following the shape of the hedge or shrub. A slight tilt downwards of the cutting device in the direction of motion is recommended for optimum cutting performance.
- Do not rush and do not attempt to cut too much with one stroke of the cutting device.
- First cut both sides from the bottom cutting upwards to the top. This will prevent any of the cuttings falling into the path of the area still to be cut (see Fig. 9).
- After cutting the sides proceed to the top (see Fig. 10).

NOTE: Try to keep the cutting device angled at approximately 15° to the cutting surface.

- Cut in a number of stages if the area being cut is particularly long to achieve a better result; smaller cuttings will allow for easy composting.

NOTE: When shaping it is advisable to achieve a trapezoidal shape (see Fig. 11). This is where the bottom is wider than the top. A trapezoidal cut corresponds to the natural growth of plants and results in optimal hedge growing, as it will expose more light to the lower end of the hedge.

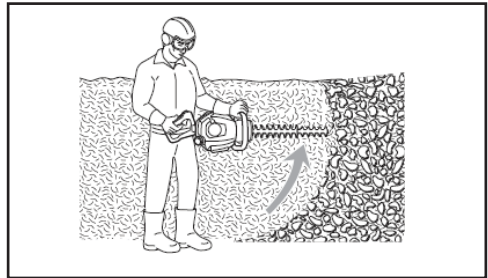

Fig. 9

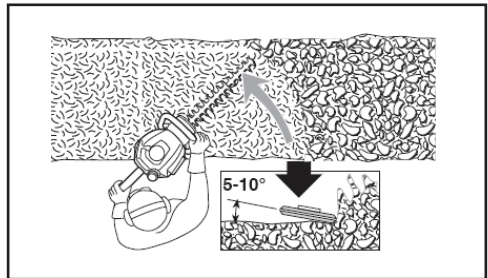

Fig. 10

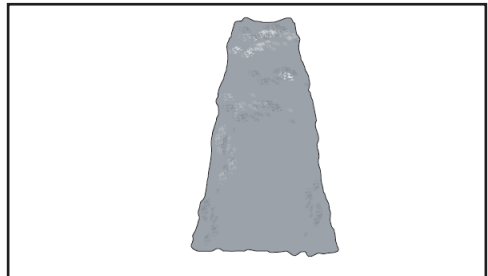

Fig. 11



# OPERATION

## ROTARY HANDLE

- The hedge trimmer's rear handle can be set in three positions by press down the button on the handle (see Fig. 12, 13, 14).

When the handle is adjusted the hedge trimmer should be idling or not running.

- While working the handle should always be facing upwards irrespective of how the hedge trimmer is directed

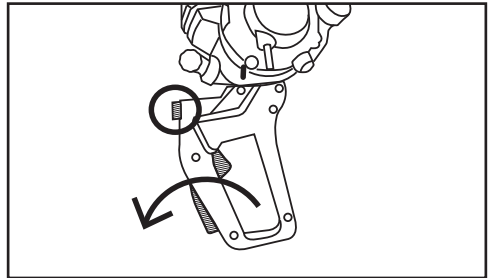

Fig. 12

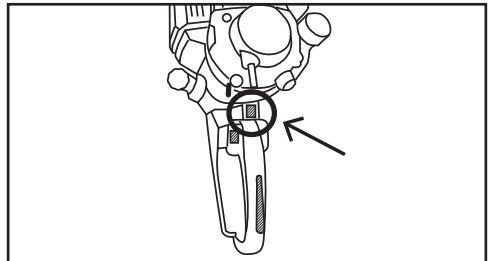

Fig. 13

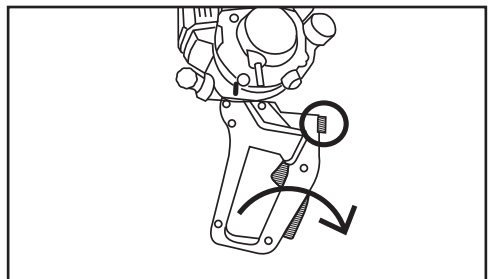

Fig. 14

# MAINTENANCE

## ENGINE OIL REPLACEMENT



**WARNING.** Old engine oil is considered special waste and has to be disposed according to your local environment protection regulation. Do not pour the oil to garbage can, sewer, soil etc.

1. The engine oil replacement is easier if engine is warm (NOT HOT!).
2. Open the oil tank cap and drain the old oil to an approved container.
3. Return the engine to an upright position and refill with lubricant following the instructions in the Adding/Checking Engine Oil section in this manual.
4. Clean the oil dropped on the unit if necessary.

## CLEANING THE AIR FILTER

1. The air filter elements should be cleaned to provide the engine abundant clean air which benefits the starting, power and life time of the engine.
2. Remove the air filter cover. To remove, press the Red button on the top of the cover with thumb and gently push up the cover with index finger, (see Fig. 15).
3. Remove the air filter (see Fig.16).
4. If only cleaning of the air filter is necessary, take the air filter pad out and clean it with a jet of dry compressed air until all dusts are removed. Wear protecting goggles and mask to protect your health during this work.
5. Reinstall the air filter cover by closing the air filter cover over the button on the housing, then push the cover until it locks securely in place.

**NOTE:** Make sure the filter is seated properly inside the cover. Installing the filter incorrectly will allow dirt to enter the engine, causing rapid engine wear. If the nylon filter element is lost, it should be reinstalled by contacting customer support.

## SPARK PLUG

Do not attempt to remove the spark plug from a hot engine.

Clean or replace the spark plug if it is soiled with heavy oil deposits.

Replace the spark plug if the centre electrode is worn at the end.

This engine uses either a TORCH CMR5H or a NGK CMR5H spark plug with a 0.6-0.8mm electrode gap, (see Fig. 17). Use an exact replacement and replace annually.

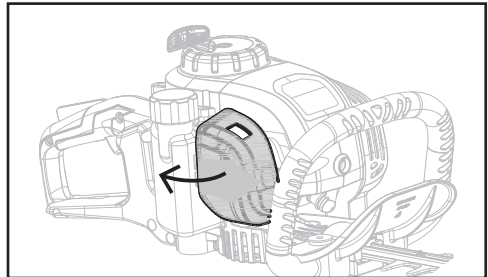

Fig. 15

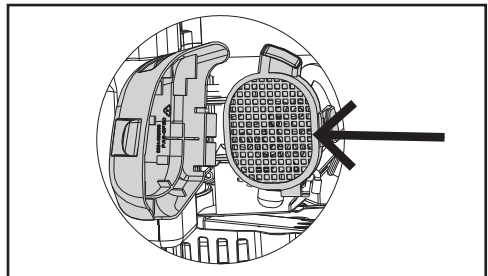

Fig. 16

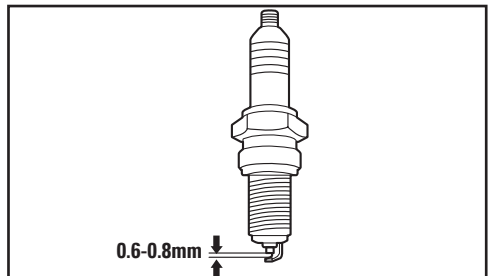

Fig. 17

1. Pull out the spark plug cap and clean the dust in the spark plug area.
2. Screw out the spark plug with the provided socket wrench.
3. Check the ceramic isolation. Replace the spark plug if damaged.
4. Clean the electrodes (metal tip) to refresh the surfaces.
5. Restore the spark plug and its cap.

# MAINTENANCE

## MUFFLER

The muffler is designed to keep noise levels to a minimum and to direct exhaust fumes away from the user. (see Fig. 19)

For mufflers it is very important that you follow the instructions on checking, maintaining and servicing your machine.

Never use a machine that has a faulty muffler. (see Fig. 20)



**WARNING!** The exhaust fumes from the engine are hot and may contain sparks which can start a fire. Never start the machine indoors or near combustible material!



**WARNING!** The inside of the muffler contain chemicals that may be carcinogenic. Avoid contact with these elements in the event of a damaged muffler.

**CAUTION!** The muffler is designed to reduce the noise level and to direct the exhaust gases away from the operator. The exhaust gases are hot and can contain sparks, which may cause fire if directed against dry and combustible material.

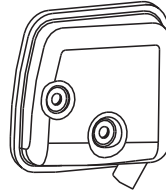

Fig. 18



Fig. 19

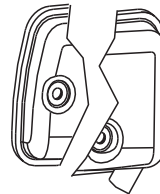

Fig. 20

# MAINTENANCE

## THROTTLE LOCKOUT

The throttle lockout is designed to prevent accidental operation of the throttle control. When you press the lockout (2) (i.e. when you grasp the handle) it releases the throttle control (see Fig. 21).

When you release the handle, the throttle control and the throttle lockout both move back to their original positions. This movement is controlled by two independent return springs. This arrangement means that the throttle control is automatically locked at the idle setting.

Make sure the throttle control is locked at the idle setting when the throttle lockout is released.

Press the throttle lockout and make sure it returns to its original position when you release it.

Check that the throttle control and throttle lockout move freely and that the return springs work properly.

See instructions under the heading Start. Start the hedge trimmer and apply full throttle.

Release the throttle control and check that the blades stop and remain stationary.

If the blades move when the throttle control is in the idle position then the carburetor idle setting must be adjusted.

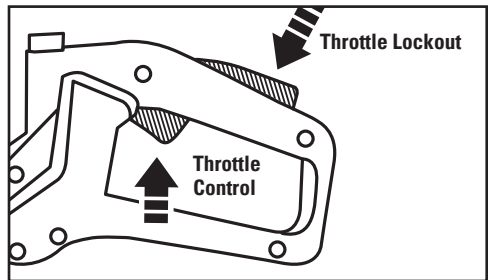

Fig. 21

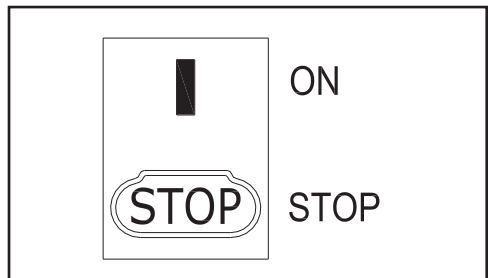

Fig. 22

## STOP SWITCH

Use the stop switch to switch off the engine. (see Fig. 22)

Start the engine and make sure the engine stops when you move the stop switch to the stop setting.

# MAINTENANCE

## GEAR

There is a grease nipple and a plug for filling lubricant on the gear housing. Use a grease gun to fill with grease. This should be done after every 25 working hours. (see Fig. 23)

**CAUTION!** The gear housing must not be filled completely with grease. The grease expands as the machine heats up during operation. If the gear housing was completely filled with grease it could damage the seals and lead to leakage of grease.

The grease in the bevel gear does not normally need to be changed except if repairs are carried out.

**NOTE:** The gear housing gets hot when the machine has been in use. To avoid burning yourself do not touch the gear housing.

## CUTTING BLADE

Clean any resin and plant residue from the blades using cleaning agent before and after using the machine.

Lubricate the blade bars with rust preventive oil before long periods of storage. (see Fig. 24)

To ensure good cutting results it is important that the contact pressure between the blades is correct. The contact pressure is adjusted by turning the screws on the underside of the bar clockwise as far as they will go. Lock the screws using the locking nut on the top of the bar. (see Fig. 25)

Check that the screws are loose enough to allow the washers under the screw heads to slide sideways.

When the blades are correctly adjusted the play between the blades should be 0,2–0,4 mm, measured at the screws.

The edges of the blades are too hard to be filed. Dull blades should be sharpened using a grinder.

Replace the blades if they are bent or damaged.

## HAND GUARD

The hand guard prevents hands from coming into contact with the moving blades, for example, if the operator loses grip on the front handle. (see Fig. 26)

Check that the hand guard is fitted correctly.

Check that the hand guard is undamaged

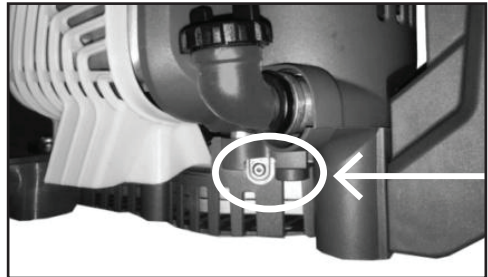

Fig. 23

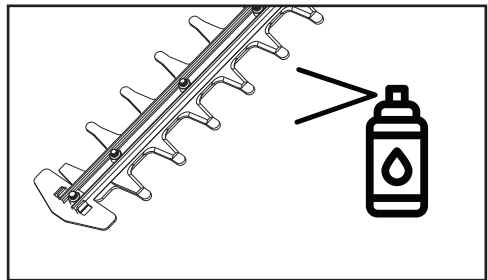

Fig. 24

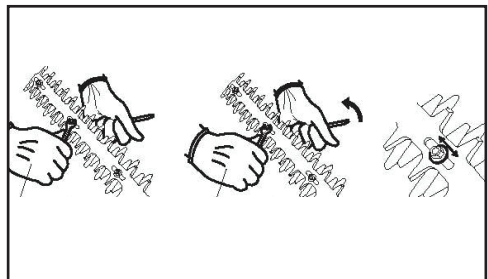

Fig. 25

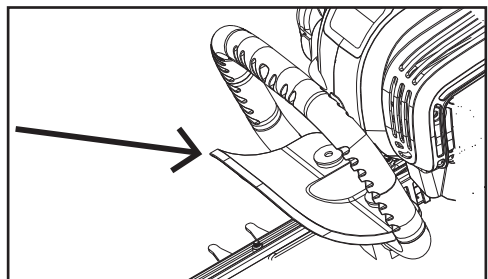

Fig. 26

<b>Problem</b>	<b>Possible Cause</b>	<b>Solution</b>
Engine will not start	No spark	Check spark. Remove spark plug. Reattach the spark plug cap and lay spark plug on metal cylinder. Pull the starter rope and watch for spark at spark plug tip. If there is no spark, repeat test with a new spark plug.
	No fuel	Push primer bulb until bulb is full of fuel. If bulb does not fill, primary fuel delivery system is blocked. Contact a servicing dealer. If primer bulb fills, engine may be flooded, proceed to next item.
	Engine is flooded	Set the choke lever to the FULL CHOKE position. Squeeze the trigger and pull the rope repeatedly until the engine starts and runs. NOTE: Depending on the severity of the flooding, this may require numerous pulls of the rope.
Engine does not reach full speed and emits excessive smoke	Air filter is dirty	Clean air filter. Refer to "Cleaning the Air Filter" earlier in this manual.
	Spark arrestor screen is dirty	Contact a servicing dealer.
	Spark plug fouled	Clean or replace spark plug. Reset spark plug gap. Refer to "Spark Plug" section earlier in this manual.
Engine starts, runs, and accelerates but will not idle.	Idle speed screw on carburettor needs adjustment.	Turn idle speed screw clockwise to increase idle speed.
Engine emits too much smoke.	Too much oil in crankcase.	Drain oil and refill with correct amount of 10W-30 engine lubricant. See "Adding/Checking Engine Oil" in the Operation section of this manual.
Unsatisfactory cutting performance	Cutting blade is dull / damaged	Have a specialist to sharpen or replace.
	Cutting material exceeds capacity	Only cut materials according to the capacity of the product

This Service is to be complete within 20 hours or 3 months of purchase, which ever comes first.

Replace	Replace
Air filter	Spark plug
Oil	
Authorised Service Agent (Name or Company Stamp)	
Technician	
Date	

This Service is to be complete within 40 hours or 6 months of purchase, which ever comes first.

Replace	Replace
Air filter	Spark plug
Oil	
Authorised Service Agent (Name or Company Stamp)	
Technician	
Date	

This Service is to be complete within 60 hours or 9 months of purchase, which ever comes first.

Replace	Replace
Air filter	Spark plug
Oil	
Authorised Service Agent (Name or Company Stamp)	
Technician	
Date	

This Service is to be complete within 80 hours or 12 months of purchase, which ever comes first.

Replace	Replace
Air filter	Spark plug
Oil	
Authorised Service Agent (Name or Company Stamp)	
Technician	
Date	

This Service is to be complete within 100 hours or 15 months of purchase, which ever comes first.

Replace	Replace
Air filter	Spark plug
Oil	
Authorised Service Agent (Name or Company Stamp)	
Technician	
Date	

This Service is to be complete within 120 hours or 18 months of purchase, which ever comes first.

Replace	Replace
Air filter	Spark plug
Oil	
Authorised Service Agent (Name or Company Stamp)	
Technician	
Date	

This Service is to be complete within 140 hours or 21 months of purchase, which ever comes first.

Replace	Replace
Air filter	Spark plug
Oil	
Authorised Service Agent (Name or Company Stamp)	
Technician	
Date	

This Service is to be complete within 160 hours or 24 months of purchase, which ever comes first.

Replace	Replace
Air filter	Spark plug
Oil	
Authorised Service Agent (Name or Company Stamp)	
Technician	
Date	

**For any queries or assistance call**



**Customer Service**

**AUST. 1300 660 457**

**NZ 0800 474 876**

**[www.stanleyproducts.com.au](http://www.stanleyproducts.com.au)**

Hours of operation:

Monday to Friday 8.00am - 5.00pm AEST

**Do not return to place of purchase.**

Keep your purchase receipt, this will be required to  
make any claims under the 2 year warranty.

**STANLEY**  **STANLEY**<sup>®</sup>

STANLEY, The STANLEY Logo, The Notched Rectangle and the Yellow and Black Diagonal Package Design are all trademarks of Stanley Black & Decker, Inc. or an affiliate thereof.